

BASEMENT LEVEL NOTES:
 FROST LINE DEPTH AT WALKOUT TO BE 18"

54'-0"

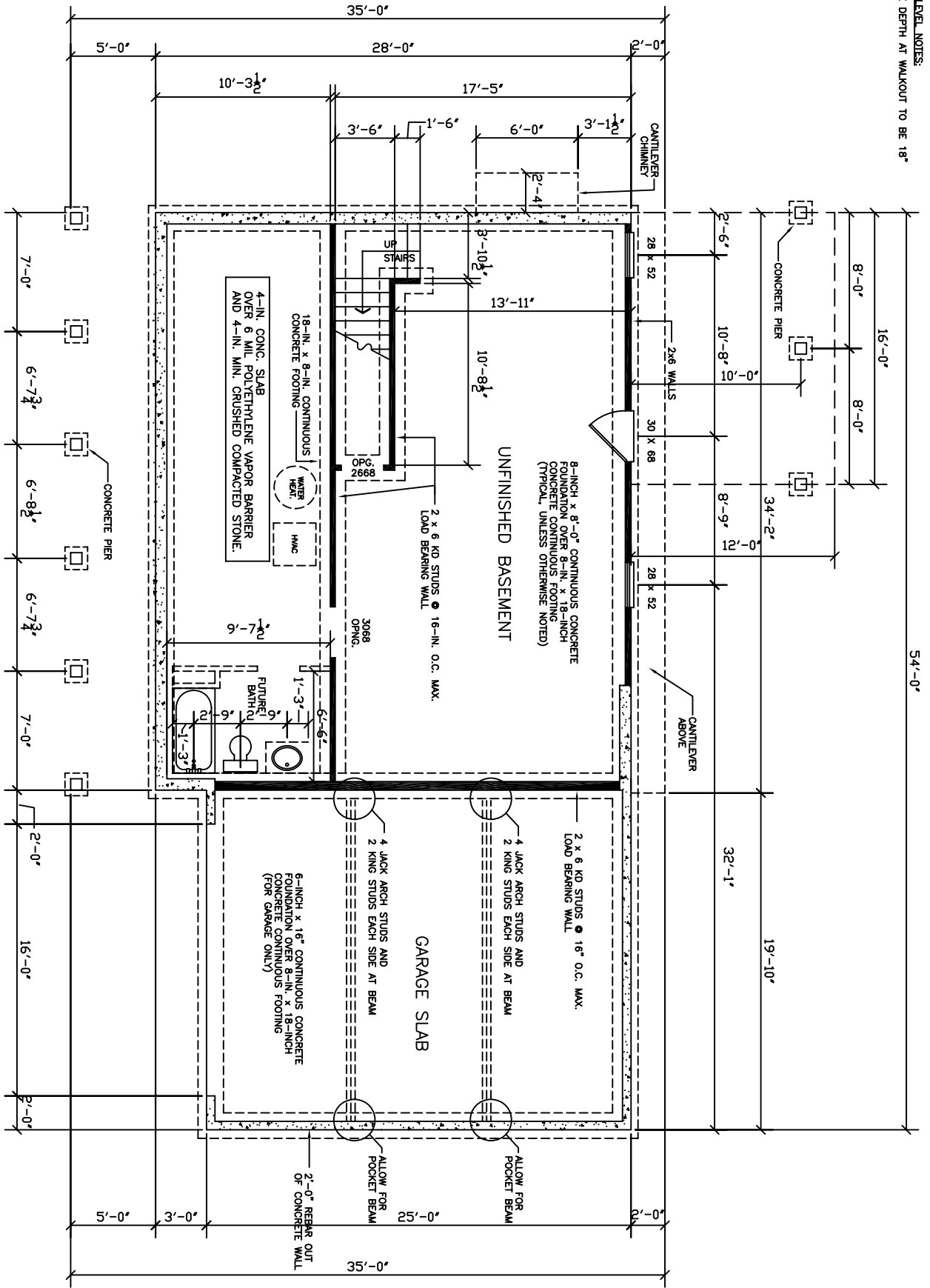

BASEMENT FOUNDATION PLAN

DATE: 03/01/05
 SHEET: B-1

THE TATE
 Lot 23

2000SF

DESIGNED BY
 FRANK BETZ ASSOCIATES, INC.
 1800 LAKE PARK DRIVE/SUITE 101
 SMYRNA, GEORGIA 30080
 404/431-0888

